



VALDEZ SPIRIT

CatFacts



The Valdez Spirit operates 9 hour glacier and wildlife cruises in Alaska.

SPECIFICATIONS	
Length	83'
Beam	29.2'
Draft	3.2'
Passengers	149
Engines	2 x Luger L6170A
Rating	800 hp @ 2000 rpm
Fuel Capacity	2000 gal.
Propulsion	Osborne Props. (5 Blade)
Speed	20 kn. Cruise / 25 kn. Top
Construction	Aluminum - Marine Grade
Builder	All American Marine, Inc.
Designer	Teknicraft Design, Ltd.
Launched	May 2005
Classification	USCG Subchapter T

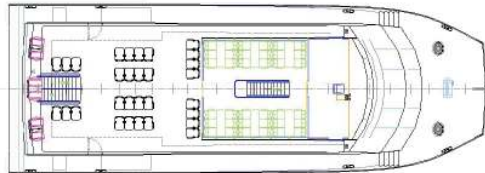
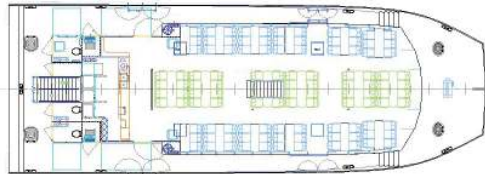
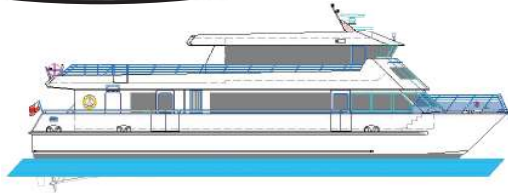

The Next Generation
in Catamaran Design

www.allamericanmarine.com

The Valdez Spirit is a 83' x 29.2' Teknicraft catamaran owned by Stan Stephens Cruises Inc. The vessel is used for glacier and wildlife cruises in Prince William Sound and operates out of Valdez, Alaska. The Valdez Spirit carries 149 passengers on 9 hour cruises during the summer season.

The vessel features a functional interior with a spacious main cabin including two comfortable seating options and an on board galley, designed to serve two meals during the cruise. Each feature of the boat was custom tailored to meet the owner's exact requirements.

Valdez Spirit owner, Stan Stephens comments: "We designed the boat the way we did because of the cost of fuel. We thought we would have to sacrifice speed for better fuel consumption and that simply wasn't the case. We were looking for a big platform and the boat is more than we had expected; we are really pleased with it and the All American Marine Crew."

The Valdez Spirit is powered by twin Luger L6170A engines, each delivering 800 hp at 2000 rpm and connected to ZF 1900A gears and Osborne propellers.



For more information contact:
All American Marine, Inc.
 200 Harris Avenue
 Bellingham, Washington 98225
 Ph. 360.647.7602
 Fx. 360.647.7607
 Email: sales@allamericanmarine.com
 Web: www.allamericanmarine.com