



teknicraft design

LION Foundation Rescue

15.5m Coastguard Catamaran



Teknicraft Design Ltd was commissioned to design a 15.15m long Coastguard catamaran for operation along the coast of New Zealand. The vessel was delivered in January 2015.

The primary function of the vessel is to conduct maritime search and rescue missions, however as a multi-role vessel it may also be deployed for the following missions:

- * Assist and/or tow damaged or disabled vessels
- * Support of aerial operations
- * Surveillance operations
- * On-scene command function
- * Transport of sick and injured persons
- * Promotion of boating safety
- * Mother ship role

The main deck layout consists of an ambulance bay with medical equipment and a spacious saloon including open galley and dining area. Four cabins located in the vessels hull accommodate up to 6 persons. The wheelhouse provides 360degree views for optimized visibility in search and rescue missions as well as for manoeuvring.

The transom is fitted with a large hydraulic platform that lowers below the waterline to enable an injured person to be lifted from the water onto the deck. The tender stows below the deck and can be deployed and retrieved whilst the vessel is under way.

LION Foundation Rescue	
SPECIFICATIONS	
Length (OA):	15.15m (49.7ft)
Length (Hull):	13.95m (45.8ft)
Beam (Moulded):	5.8m (19ft)
Draft:	0.85m (2.8ft)
Engines:	2 x Scania DI 13 077M
Rating:	551kW (739bhp) @2300rpm
Propulsion:	2 x Hamilton Jet HJ364
Speed:	27 knots (service) 35 knots (max)
Construction material:	Aluminium
Builder:	Q-West Boat Builders, New Zealand



LION Foundation Rescue

General Arrangement

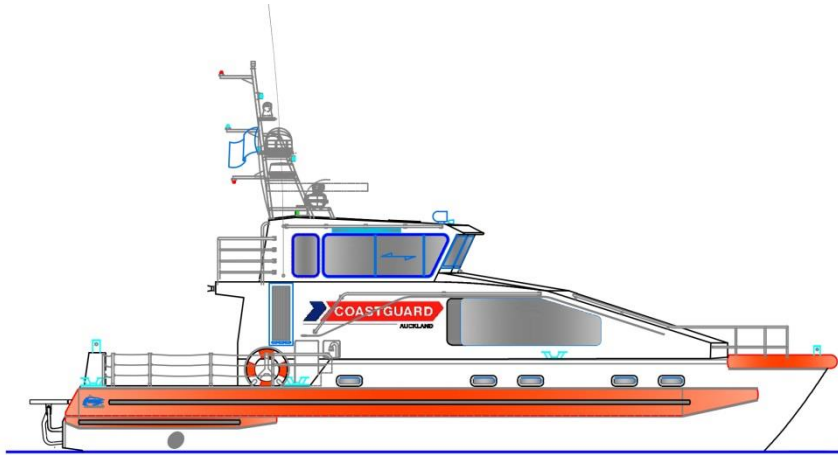

OUTBOARD PROFILE

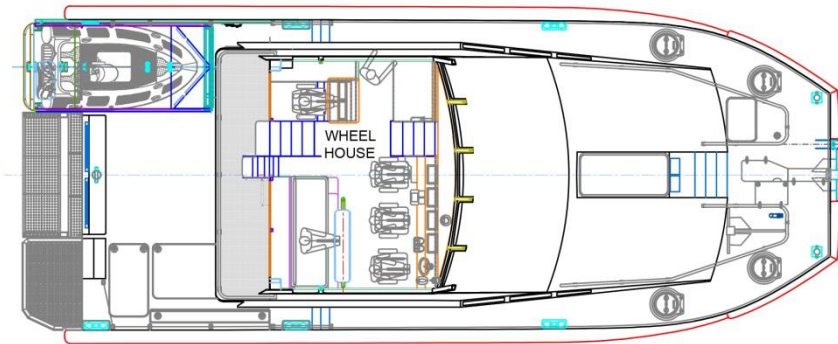

WHEEL HOUSE ARRANGEMENT

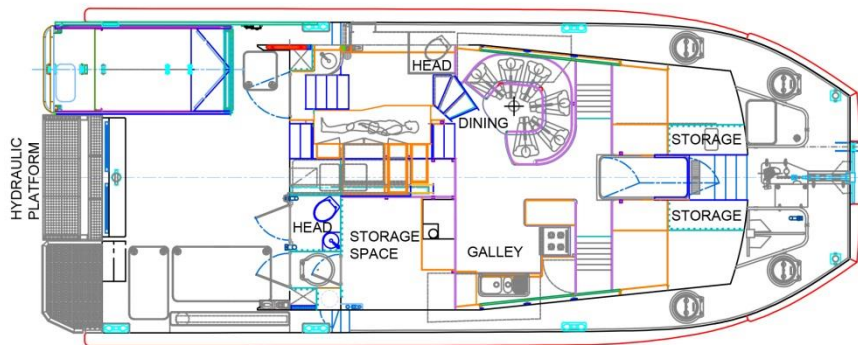

MAIN DECK ARRANGEMENT

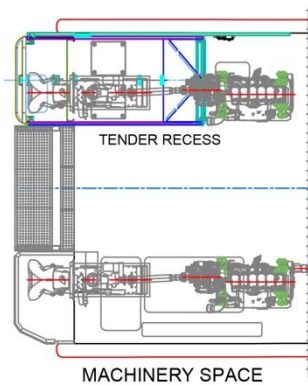

MACHINERY SPACE

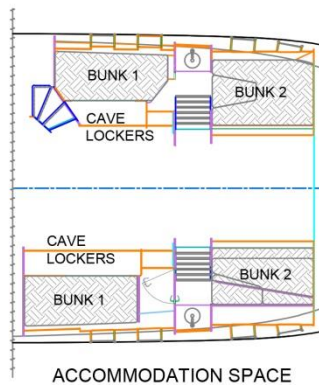

ACCOMMODATION SPACE