



Teknicraft has designed a 18.85m long Survey catamaran for operation within restricted coastal areas along the coast of New Zealand, with the primary function of hydrographic survey missions. However as a multi-role vessel it may also be deployed for various other missions.

The foil supported catamaran-hull is designed for high speed and constructed of high strength Alcan Sealium aluminium alloy.

The vessel can accommodate up to 6 persons overnight, in cabins located in the hull and one master bedroom on the main deck. The master bedroom is furnished with a king-size bed and has an en-suite bathroom. The spacious lounge- and dining area is designed to fit up to 12 day passengers.

Ten Seventy	
SPECIFICATIONS	
Length (OA):	18.85m (61.8ft)
Length (Hull):	17.5m (57.4ft)
Beam (Moulded):	6.8m (22.3ft)
Draft:	0.85m (2.8ft)
Engines:	2 x MAN 8V-1200
Rating:	882kW (1182bhp) @2300rpm
Propulsion:	2 x Hamilton Jet HJ403
Speed:	30 knots (service) 45 knots (max)
Construction material:	Aluminium
Builder:	Q-West Boat Builders, New Zealand



TEN SEVENTY

General Arrangement

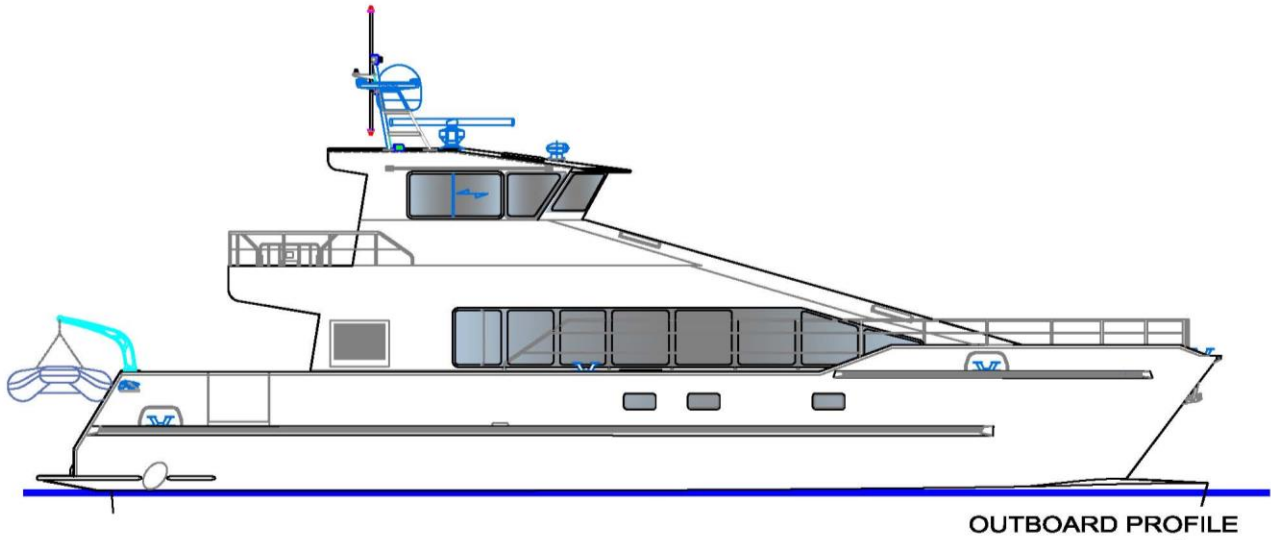

OUTBOARD PROFILE

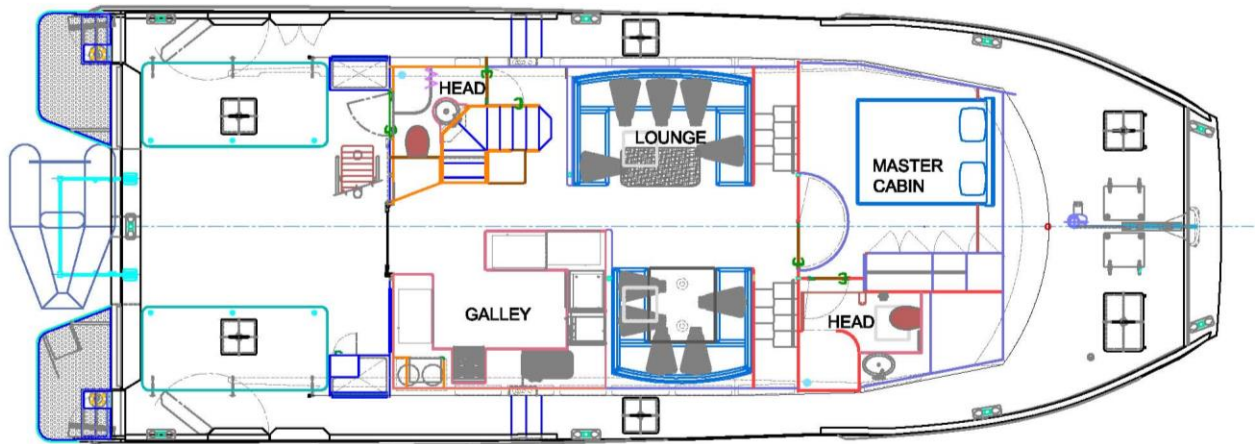

MAIN DECK ARRANGEMENT

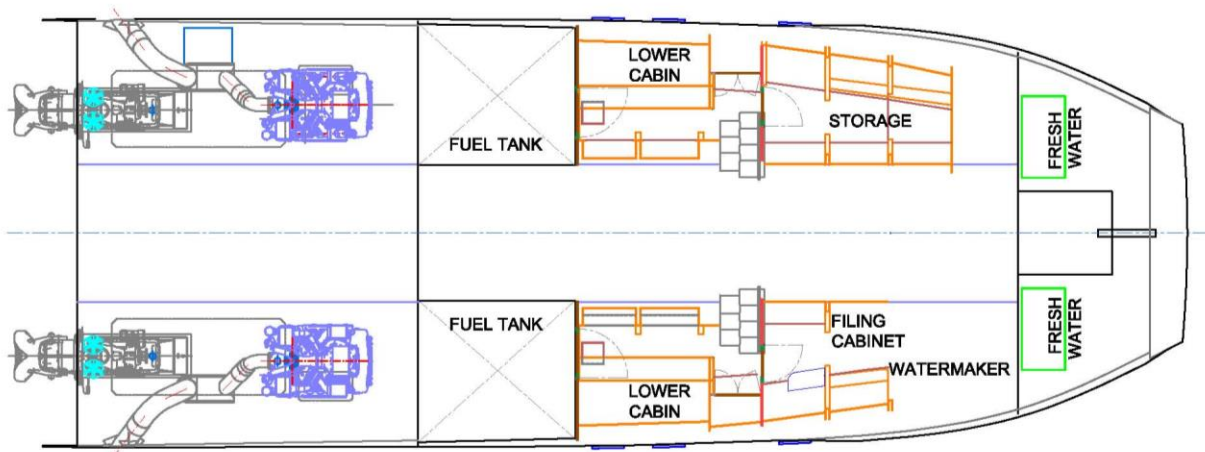

LOWER DECK ARRANGEMENT